

FENCE/ACCESSORY BUILDING PERMIT

City of Casper
Community Development Department
200 North David, Casper, WY 82601
235-8254/Fax 235-8362

Fence (Complete this section for a fence.)	Accessory Building (Complete this section for an accessory building under 120 square feet.)
Property Owner:	Property Owner:
Fence Address:	Accessory Building Address:
Fence Location (front/side/rear):	Accessory Building Location (front/side/rear):
NOTE: Fences must meet applicable height requirements and must be located on your property.	NOTE: Accessory buildings must meet applicable setbacks and cannot be located in an easement.
Property Owner's Mailing Address/Phone #:	Property Owner's Mailing Address/Phone #:
Contractor's Name/Mailing Address/Phone #:	Contractor's Name/Mailing Address/Phone #:
Fence Materials and Height:	Accessory Building Dimensions and Materials:

*Complete plot plan on back of this form for either a fence or accessory building.

Approved by: _____ **Date Issued:** _____
(Inspector)

Comments:

VALIDITY: The issuance or granting of a permit or approval of plans and specifications shall not be construed to be a permit for, or an approval of, any violation of any of the provisions of this Code. No permit presuming to give authority to violate or cancel the provisions of this Code shall be valid, except in so far as the work or use which it authorizes is lawful.

The City of Casper does not require the home owner to provide a survey of their property; however, it is the responsible of the home owner to know where their property lines are prior to erecting a fence. The City of Casper is not liable for any fence that is constructed outside of the home owners' property lines. The issuance of a permit based upon plans and specifications shall not prevent the Inspector from thereafter requiring the correction of errors in said plans and specifications or from preventing building operations being carried on thereunder when in violation of this Code or of any other ordinance of the City.

EXPIRATION: Every permit issued by the Inspector under the provisions of this Code shall expire by limitation and become null and void if the building or work authorized by such permit is not commenced within 60 days from the date of such permit, or if the building or work authorized by such permit is suspended or abandoned at any time after the work is commenced for a period of 120 days. Before such work can be recommenced, a new permit shall be obtained, provided no changes have been made or will be made in the original plans and specifications for such work; and provided further, that such suspension or abandonment has not exceeded one year.

SUSPENSION OR REVOCATION: The Inspector may, in writing, suspend or revoke a permit issued under the provisions of this Code whenever the permit is issued in error or on the basis of incorrect information supplied, or in violation of any ordinance or regulation or any of the provisions of this Code.

I hereby acknowledge that I have read this application and state that the above is correct and agree to comply with all City ordinances and state laws regulating fence or accessory building construction. I attest that the fence/accessory building I am constructing is entirely located on my own property, and that I will contact the Community Development Department, Code Enforcement Division at 235-8254, upon completion of the fence or accessory building to request a final inspection.

Signature: _____ **Date:** _____

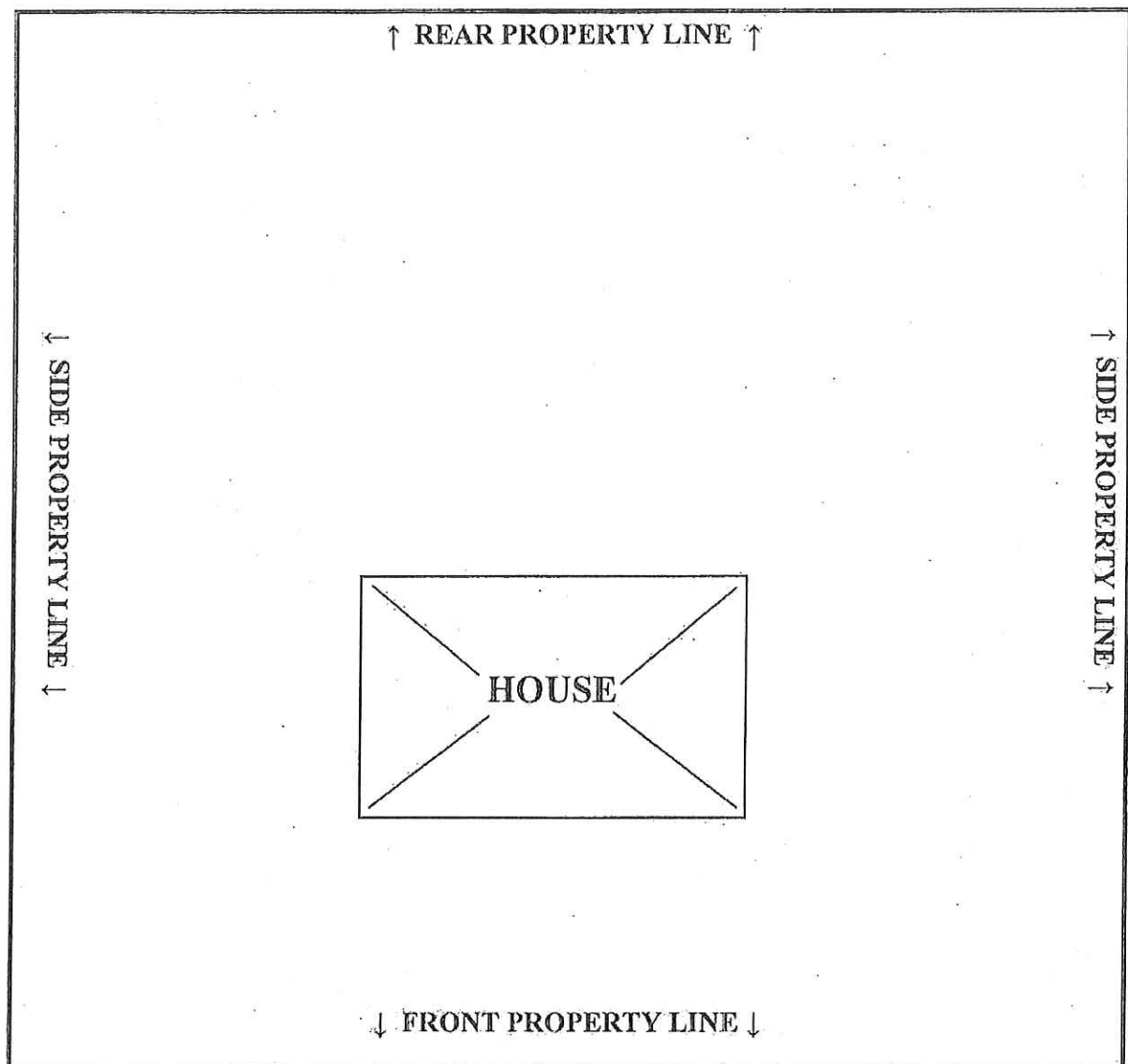

SIDEWALK

PARKWAY

STREET